



AAON Roof Curbs

Technical Product Information

RN 26-70 Tons- "D" Cabinet with Side Discharge

P.O. NUMBER _____

CUSTOMER _____

PROJECT _____

LOCATION _____

ARCHITECT _____

STANDARD CONSTRUCTION

- ____ GAUGE GALVANIZED STEEL
- 2 x 2 WOOD NAILER
- 1" DUCT LINER INSULATION
- UNITIZED CONSTRUCTION
- CONTINUOUS WELDED CORNER SEAMS

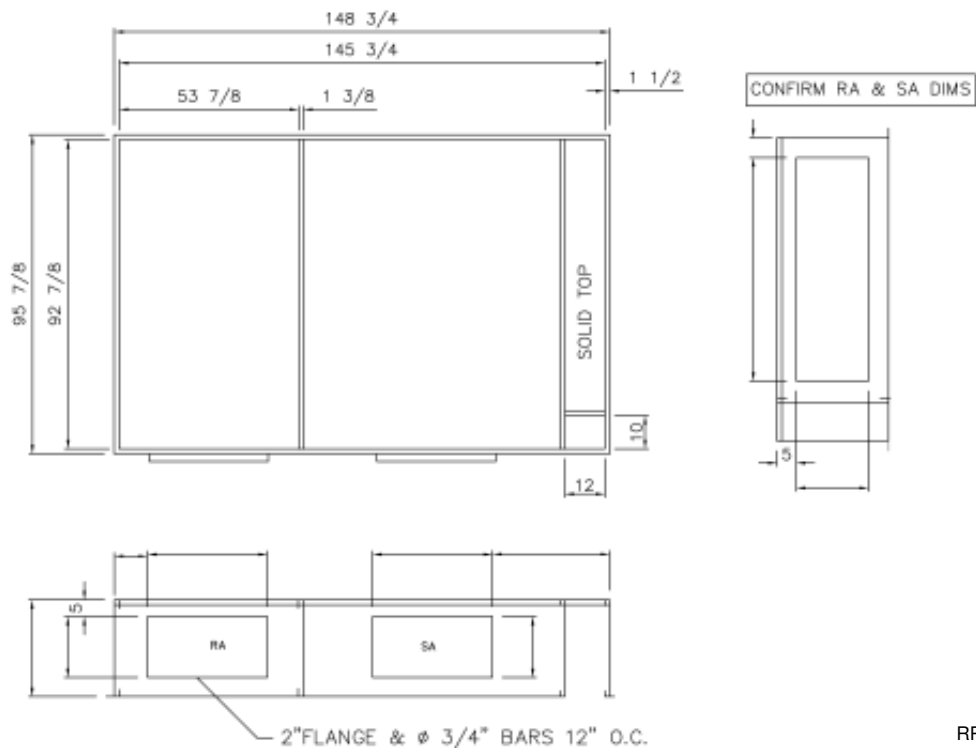

RPS CAD D-146-SIDE

PROJECT REQUIREMENTS

QTY.	STYLE	* OVERALL HEIGHT	PITCH REQUIREMENTS		TAG
			LONG SIDE	SHORT SIDE	